

ASSEMBLY INSTRUCTION for 7" Device on 110cm Floor Pedestal #B

Thank you for purchasing the CAN-AM Howen AI Automated Temperature Screening kiosk.

For any support question, please call 1-866-976-4177 ext 1001 or email support@canamwireless.com

Instruction to setup the device with 110cm floor pedestal:

1. Remove the 3 mounting screws at the bottom of floor pedestal tower. Save this screws for later step, as these are the screws to attach the floor pedestal base to the floor pedestal tower. Refer to figure 1.



Figure 1.

2. Open the three bottom feet of the floor pedestal base



Figure 2

3. Install the tower to the base, and tighten 3 screws from Step 1. Make sure that the tower hole opening is facing the connector. See figure 3.

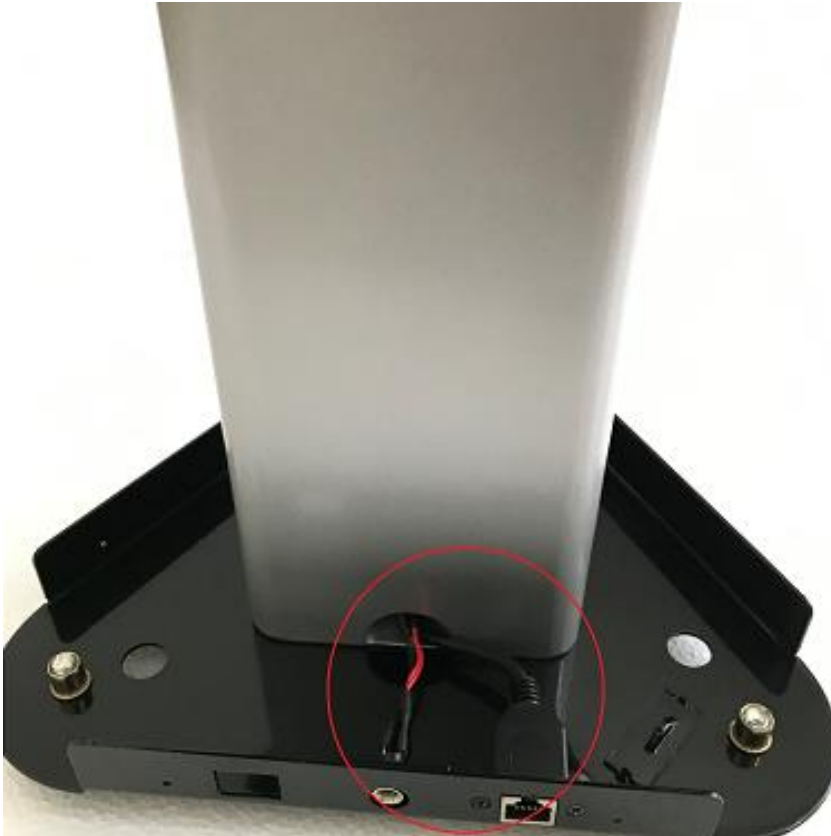

Figure 3

4. Identify the 3 wires:

- a. RJ45 Ethernet wire. Unscrew the two black screw, and install the connector to the base
- b. Two power wire (black and red).

See Figure 4. Note the short and long tab of the power connector.

Plug the black wire to the long tab, and the red wire to the short tab.

- black is negative polarity, plugs to the long pole
- red is positive polarity, plugs to the short pole

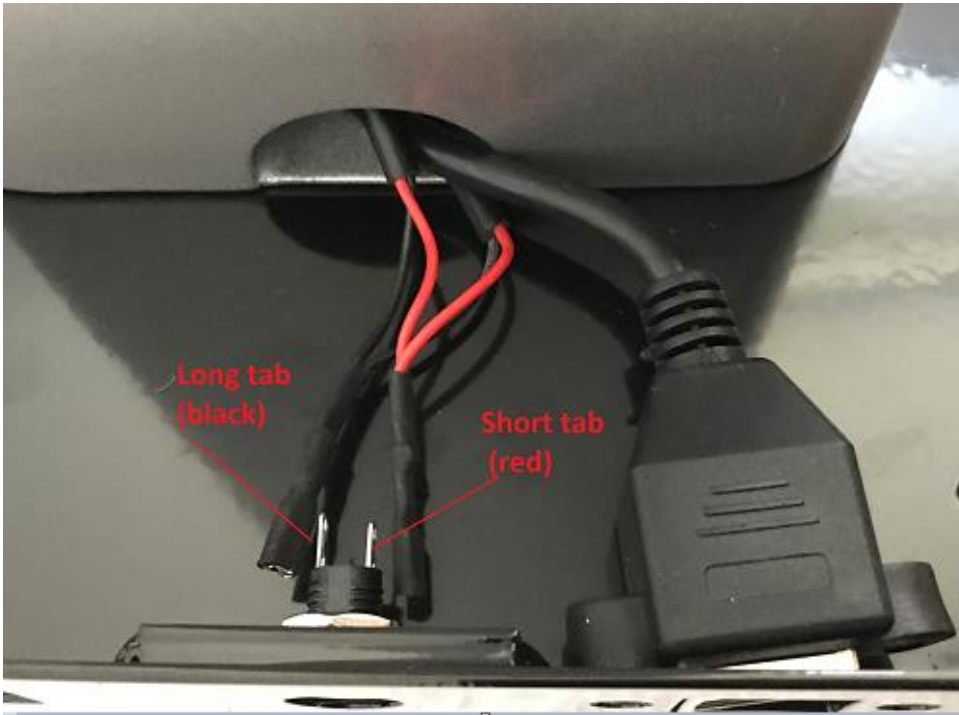

Figure 4



Figure 5

5. Install the base cover by sliding it from the top of tower, and reinstall the 4 screws securing the base cover to the base
6. Open the top cover of floor pedestal tower by unscrewing 4 screws. Refer to Figure 5.



Figure 6

7. Install the two screws using the provided Hex tool to attach the pedestal tube to the device. Refer to figure 7.



Figure 5

8. Remove the locknut at the bottom of the pedestal tube. Refer to Figure 8.

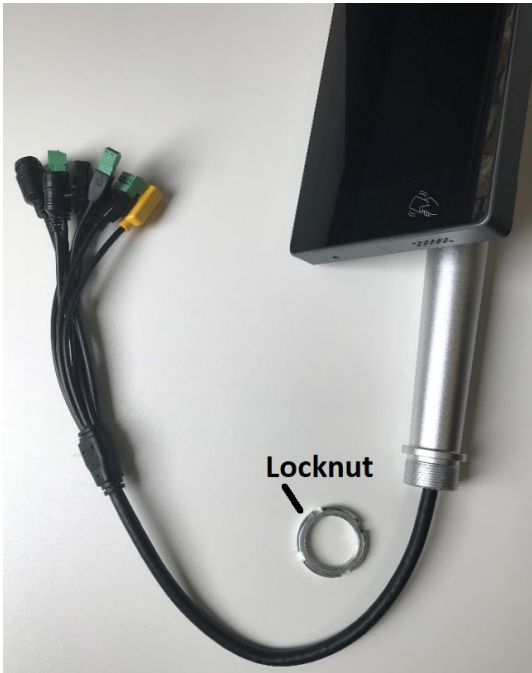

Figure 6

9. Route the black wires through the floor pedestal top cover and the locknut. Refer to Figure 9.



Figure 9

10. Secure the pedestal tube to the top cover by installing and tightening the locknut at the bottom of top cover. Refer to Figure 10.



Figure 7

11. Connect the following wires:
 - a. Power cable
 - b. Ethernet wire (RJ45)
 - c. USB:
 - i. Model with one USB cable from the floor pedestal, only connect 1 USB cable to either black or yellow USB cable from the device.



Figure 8

12. Install the top cover to the floor pedestal using the 4 screws from step 6 above
13. Connect the power adapter cable to the base of floor pedestal power port. Refer to Figure 11.

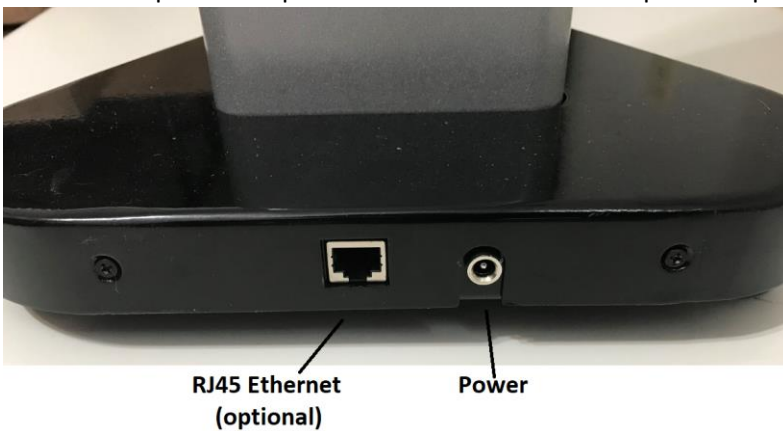

Figure 9

14. Place the stand on a flat surface.