

ASSEMBLY INSTRUCTION for 7" Device on 110cm Floor Pedestal

Thank you for purchasing the CAN-AM Howen AI Automated Temperature Screening kiosk.

For any support question, please call 1-866-976-4177 ext 1001 or email support@canamwireless.com

Instruction to setup the device with 110cm floor pedestal:

1. Remove the 3 mounting screws at the bottom of floor pedestal tower. Save this screws for later step, as these are the screws to attach the floor pedestal base to the floor pedestal tower. Refer to figure 1.

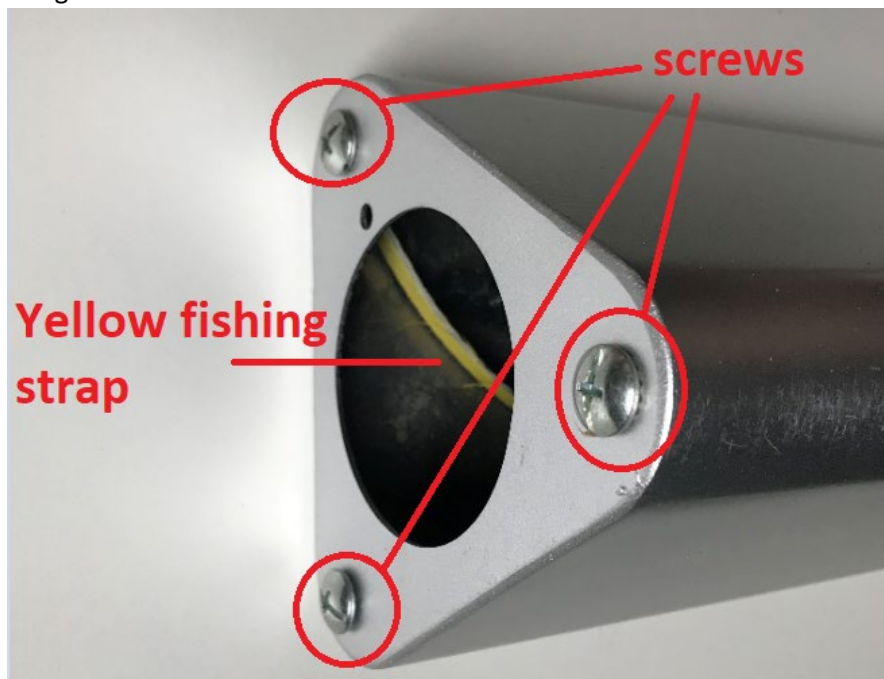

Figure 1

2. Open the three bottom feet of the floor pedestal base



Figure 2

3. Identify the 3 black wire (2 power cable connector and 1 network RJ45 connector) route it thru the center hole. Refer to figure 3.

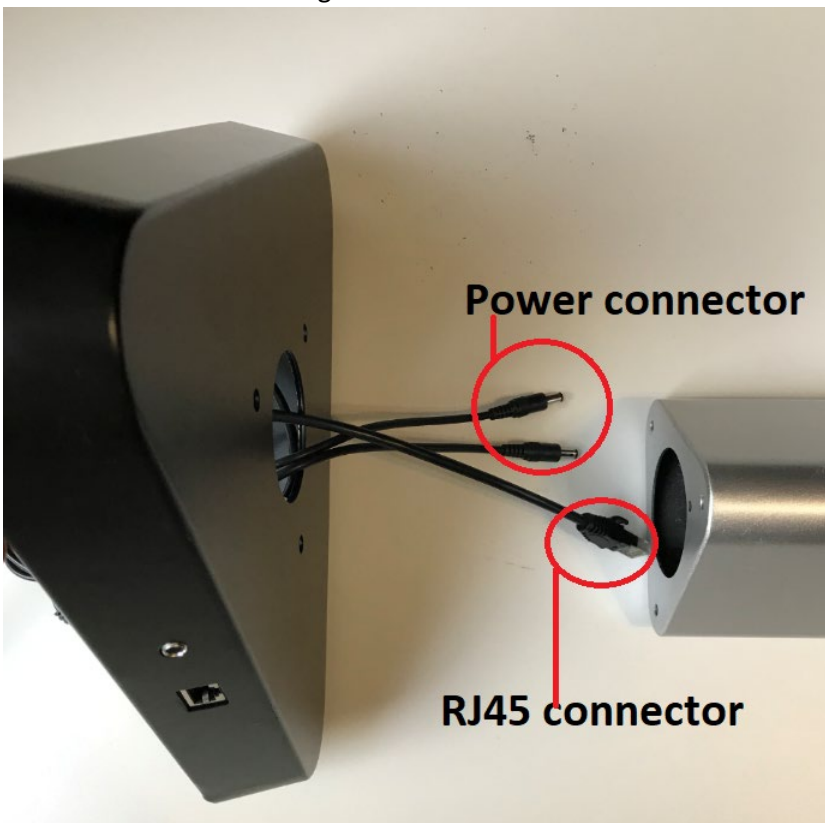

Figure 3

4. Identify a yellow fishing band/yellow strap with a black tape in the floor pedestal tower. It should be used to help fishing the 3 black cable connectors thru the floor pedestal tower. Attach the 3 black cable connector to the yellow fishing strap by looping the black adhesive tape around it. Refer to figure 4.

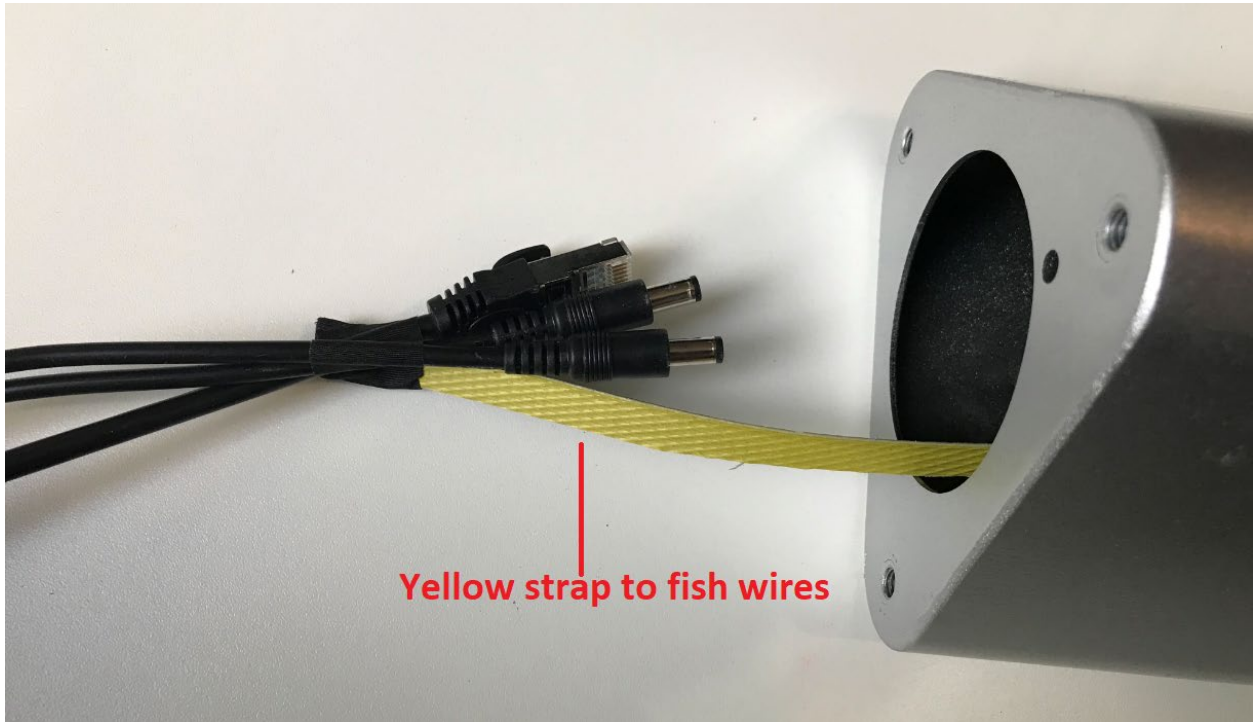

Figure 4

5. Open the top cover of floor pedestal tower by unscrewing 6 screws. Refer to Figure 5.



Figure 5

6. Find the yellow fishing strap from top of tower, run the 3 black wire from the bottom of the tower to the top of the tower by pulling the yellow strap from the top of tower.



Figure 6

7. Install the two screws using the provided Hex tool to attach the pedestal tube to the device. Refer to figure 7.



Figure 7

8. Remove the locknut at the bottom of the pedestal tube. Refer to Figure 8.



Figure 8

9. Route the black wires thru the floor pedestal top cover and the locknut. Refer to Figure 9.



Figure 9

10. Secure the pedestal tube to the top cover by installing and tightening the locknut at the bottom of top cover. Refer to Figure 10.



Figure 9

11. Connect the following wires:

- a. Power cable
- b. Ethernet wire (RJ45)
- c. USB:
 - i. Model with two USB cable from the floor pedestal, both can be connected to the device (yellow or black USB cable from the device can be connected to any cable from the floor pedestal).
 - ii. Model with one USB cable from the floor pedestal, only connect 1 USB cable to either black or yellow USB cable from the device.



Figure 10

12. Install the top cover to the floor pedestal using the 6 screws from step 5 above
13. Install the 3 mounting screws from step 1 above, to attach the base to the tower. Refer to figure 11.



Figure 11

14. Install the bottom base cover, and attach the 3 base feet from step 2 above.



Figure 11

15. Connect the power adapter cable to the base of floor pedestal power port. Refer to Figure 7.

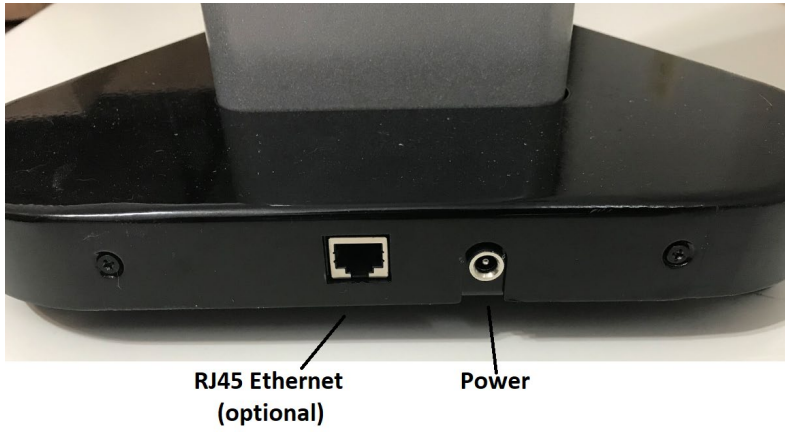

Figure 12